

Calipso Galapagos Liveaboard

Beautifully constructed, now rebuilt in 2019 for naturalist and diving cruises in the Galapagos Islands.

Calipso was completely rebuilt from the keel up. The motors, generators, compressors, cabins, salon, dining area, dive deck, sundeck... everything is brand new, fresh and modern. Everything was designed efficiently with the comfort of divers in mind.



Diving the Galapagos:

Scuba diving the Galapagos Islands is not only about sharks, it's also about the sheer abundance of marine species. Year after year, Galapagos is rated as the most healthy marine environment. In addition to sharks, we have Dolphins, Penguins, Orcas, Mola Molas, Mantas, Eagle Rays, Mobulas, Stingrays, Sea Lions, Turtles, Barracudas, Jacks, many tropical reef species as well as critters like the endemic Marine Iguanas. And that doesn't begin to cover all you will see when you dive the Galapagos!

Deck Plan & Boat Specifications:

- **Sun Deck:** You can access the sundeck from the stairs at the back of the dive deck. If you are wet, please use these stairs. On the sundeck we have the jacuzzi, a BBQ, a bar, al fresco dining and lounge chairs as well as cushioned bench seating areas.
- **Upper Deck:** The upper deck may be accessed from the stairs in the salon or the stairs on the dive deck. Cabins 1 - 6 are located on the upper deck. The Bridge and the captain's quarters are also on the upper deck. In front of the bridge is a small outdoor bench seating area.
- **Main Deck:** Our air conditioned salon has seating areas with a large TV where you will have briefings. You take meals in the dining area. We have a 24 hour coffee and tea station. We also have a bar behind the salon. Behind the dining area is a space for using and charging computers. Cabins 7 and 8 are towards the bow on the main deck. Though the aft doors is the dive deck. Just outside the doors on the dive deck is where you will refill your water bottles. The dive deck has a large 3 level stainless steel camera table, a large camera rinse tank with a shallow side for GoPros, a dry battery charging

area, diver stations, 4 hot water showers, a bathroom and racks for hanging your wetsuits.

- **Lower Deck:** The lower deck has the galley, the crew's quarters and machine rooms. Cabins 9 & 10 are on the lower deck along with the galley.

Dive Deck:

Calipso Galapagos has a spacious dive deck. Each stainless steel diver station has storage underneath. We have a deep stainless camera rinse tank and a dry charging area with shelves to accommodate your batteries. Most are 110 v, however, we do have some 220 v outlets. The large stainless camera table has 3 levels. The dive deck also has a bathroom, a towel warming station and 4 hot showers.

Each diver will have an individual dive station. Warm towels distributed after each dive will be embroidered with numbers. For hygienic continuity, please use only the towel number that corresponds with your cabin number. Please do not take these towels back to your cabin. They are only for use on the dive deck.

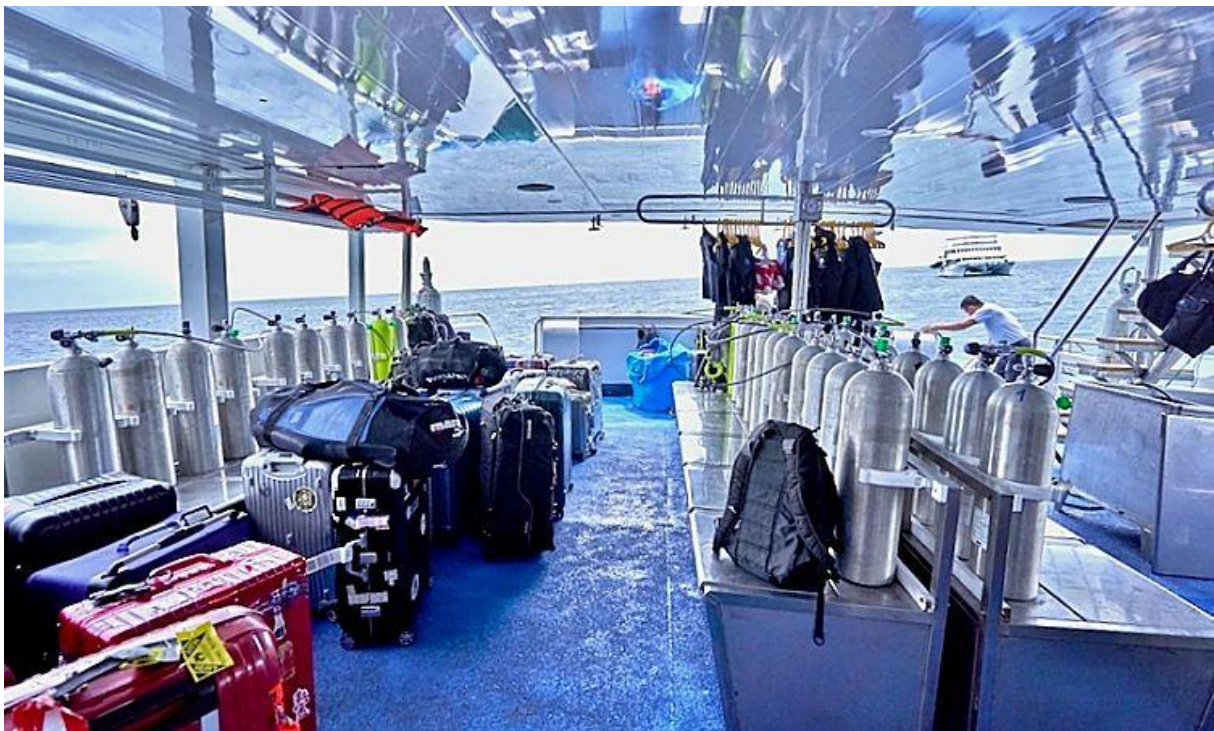

Equipment onboard:

- DIN Adaptors
- Nitrox (Extra cost)
- Rinse Hoses
- Dive deck
- Tenders for diving
- Side mount Diving
- Shaded Diving Area
- 2 ribbed zodiacs (pangas)
- 2 dive guides (1 per 8 divers)
- Individual dive stations
- Equipment rental (Extra cost)

Onboard Accommodation:

All cabins with private bathrooms, hot water and air-conditioning. Accommodation can be converted into one king size bed or 2 twin size beds cabins, except on the ones located in the lower deck.

- Main Deck: 2 Cabins (Convertible beds) 140 ft²/13.5 m², dining room, bar, social area, diving platform
- Upper Deck: 2 Cabins (Convertible beds) 120 ft²/11.2 m², 4 Cabins (Convertible beds) 130 ft²/12.2 m²
- Sun Deck: Jacuzzi, al fresco dining and social area
- Lower Deck: 2 Cabins (twin only) 120 ft²/11.3 m²



All cabins have TVs with on-demand entertainment, both video and audio. The sundeck has speakers for music. The salon has a large TV for briefings and movies. And we have a special treat - we can livestream the marine life below us at anchor into the salon TV.



Our zero carbon emission water maker onboard provides clean water, so feel free to use the faucet water when brushing your teeth. Drinking water is provided in coolers. And please note, we do not put toilet paper in the toilet in Ecuador anywhere and

onboard is no different. It goes into a closed wastebasket beside the toilet. The bags we use are biodegradable. This will be collected several times a day from your cabin.

What is food like onboard?

We provide a continental breakfast prior to your first dive, then a full breakfast. Breakfast, lunch and dinner are now served individually for COVID-19 safety precautions and organized in two separate groups. We serve international and Ecuadorian dishes prepared with fresh local produce and seafood. There is a snack and hot beverage after each dive. Fruits, candies and snacks are available all day. We can accommodate virtually any dietary requests (vegetarian, vegan, gluten free, etc.) as long as you submit them to us in a timely manner. Your requests will be included on your Diver Booking form due 90 days prior to arrival.

Safety:

We are well equipped with multiple safety features including smoke / temperature alarms, a sprinkler system throughout, multiple fire extinguishers on each level, emergency lighting, bilge pump system, searchlights, horns, life jackets and life rafts as well as first aid kits, oxygen kits, neck brace, stretcher and 2 defibrillators. Our crew is trained and certified to handle emergencies. All cabins have safety deposit boxes for your peace of mind.



Deck Plan:

This deck plan is representative of the layout, but do not rely on it for cabin sizes. Cabin 1 is not larger than the rest as it appears.

SUNDECK

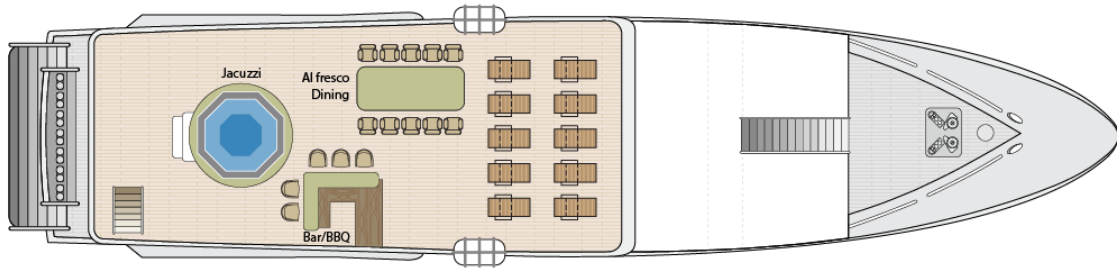

UPPERDECK

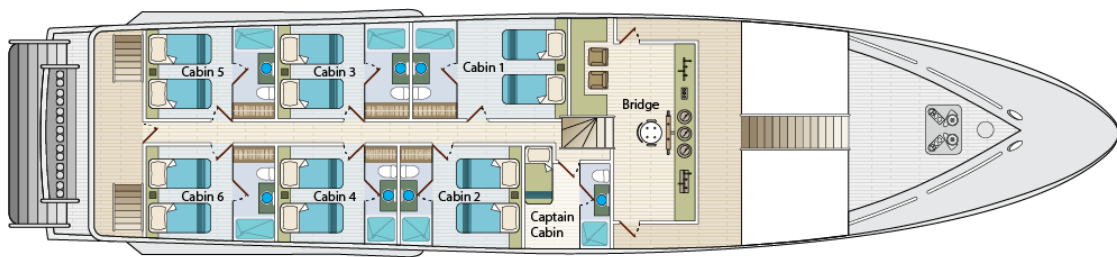

MAINDECK

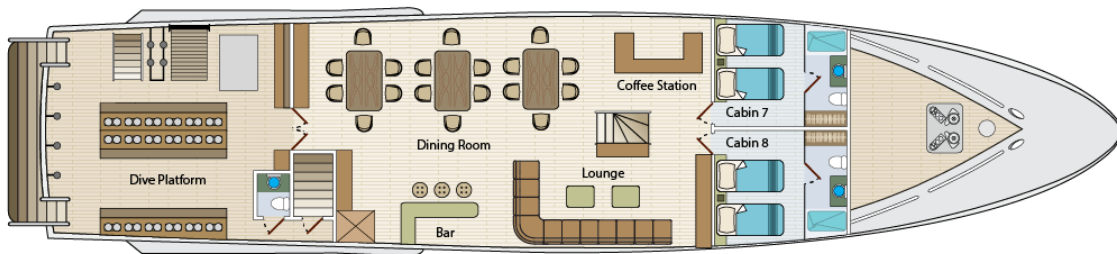

LOWERDECK

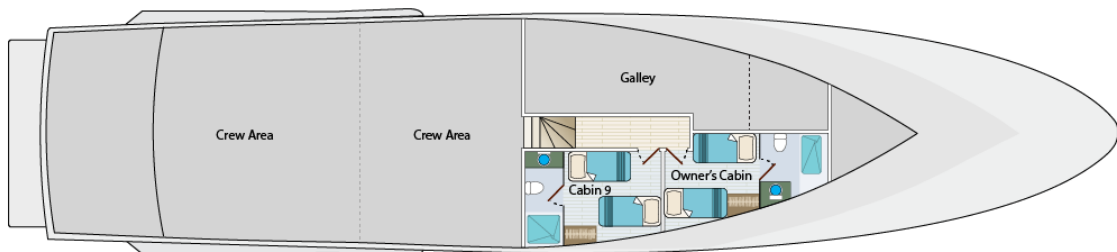

Boat Specifications:

Year of construction:	1991, rebuild on 2018-2019
Type:	Motor Yacht
Length:	35.4 m / 117 ft
Beam:	8 m / 26 ft
Engines	2 Cummins NTA855-M, 400 hp, 1800 rpm
Generators	2 Cummins 6B-CP, 99 kw, 60 hz
Compresor	Bauer Verticus model VAC20-E3, 5000 PSI
Cruising speed:	11 knots
Electricity:	110 & 220 V
Fresh Water	5,000 gallons / 20,000 liters
Fuel Capacity	7,200 gallons / 29,000 liters
Capacity	11 crew members & 16 passengers
Services onboard:	<ul style="list-style-type: none"> • Satellite Wi-Fi included, Satellite phone for emergencies • Hot water showers • Each cabin with individual climate control • Apple TV, hair dryers, safety box and USB plugs • Life jackets • Jacuzzi • Library • BBQ Area
Safety:	<ul style="list-style-type: none"> • First Aid Kits and AED • Large Oxygen Bottles and 3 Oxygen Kits – 1 for each panga • Life Jackets with and 2 Life Boats • Nautilus Lifelines, Dive Alerts, SMBs, Noisemakers • Foruno Radar and Foruno Sonar • VHF Radio • EPIRB Radio Beacon • GPS Antenna • Searchlight and Horn • Bilge Pump Alarm • Sprinkler System in all cabins and interior spaces • Fire Alarm System, Extinguishers and fire hoses • Smoke and Temperature Detectors • CO2 Bank (150 Kg)