

Calipso

Galapagos Expedition & Diving



DREAM - DIVE - DISCOVER



KEY FEATURES



- ✓ Naturalist and Diving Cruises
- ✓ Recently Rebuilt
- ✓ Brand new and beautiful cabins
- ✓ Excelent Itineraries

16
PAX

PRICES

RACK RATES	
Program Type 8 Days	
\$5495	9 July 2020 - 7 July 2021
\$5695	8 July 2021 - 6 July 2022
\$6395	7 July 2022 - 6 July 2023

INCLUDED:

- ✓ Accommodation onboard for length of cruise
- ✓ All meals, snacks & beverages (alcohol extra)
- ✓ Weights, weight belts & tanks
- ✓ Dive Alert, SMB, Nautilus Lifeline, Safety Noisemaker
- ✓ Bilingual Park certified dive guide
- ✓ Airport transfers in San Cristobal for official flight

NOT INCLUDED:

- ✗ Flights to Galapagos
- ✗ National Park Entrance Fee
- ✗ Transit Control Card (TCT)
- ✗ Recompression Chamber Fee
- ✗ Nitrox
- ✗ Equipment Rental
- ✗ Dive Insurance
- ✗ Travel-Health Insurance
- ✗ Meal on final full day in town
- ✗ Personal Expenses: alcohol, gratuities, etc
- ✗ 12% Sales Tax (VAT)
- ✗ Tips, and credit card fee

CALIPSO DIVE ITINERARIES



8-Day Diving Cruise
Thursday - Thursday

8 DAY DIVING CRUISE	
Thu	am San Cristobal: Arrival to airport: transfer to boat pm San Cristobal: Lobos Island (Check dive)
Fri	am Santa Cruz: Punta Carrion pm North Seymour
Sat	am Wolf: La Banana / La Ventana Islet pm Wolf: Shark Bay Point / El derumbe
Sun	am Darwin: Darwin's Arch pm Darwin: El Arenal
Mon	am Darwin: Darwin's Arch pm Wolf: Shark Bay Point, La Banana, Anchor bay
Tue	am (JAN-MAY) pm Isabela: Cape Marshall (JUN-DEC) pm Fernandina: Cape Douglas / Roca Point
Wed	am Santiago: Cousin Rock pm Santa Cruz: Highlands
Thu	am San Cristobal: Puerto Baquerizo Moreno pm San Cristobal: Departure

 **Charters & Groups**
Contact us for special rates!

Land Services

We offer the full range of travel experiences in the region, including: Amazon Lodges, Andes Adventures, hotels, flights, day tours and transfers. Contact us for details.

CONTACT US TODAY !!

Sales
+593-099-050-4344
+593-099-981-5500

Reservations
sales@calipsodive.com
sales2@calipsodive.com

Address
Av. Quito y Tnte. Hugo Herrera, Puerto Baquerizo Moreno, Galapagos, Ecuador



Deck Plan

SUNDECK

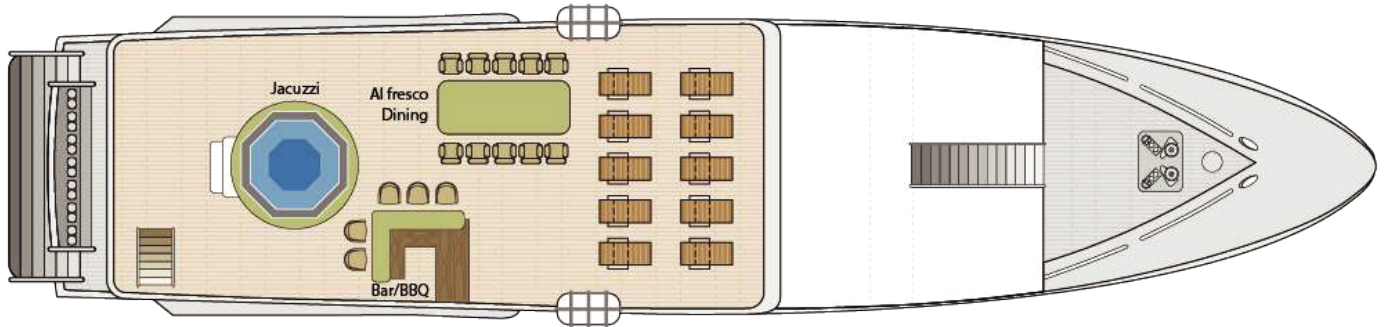

UPPERDECK

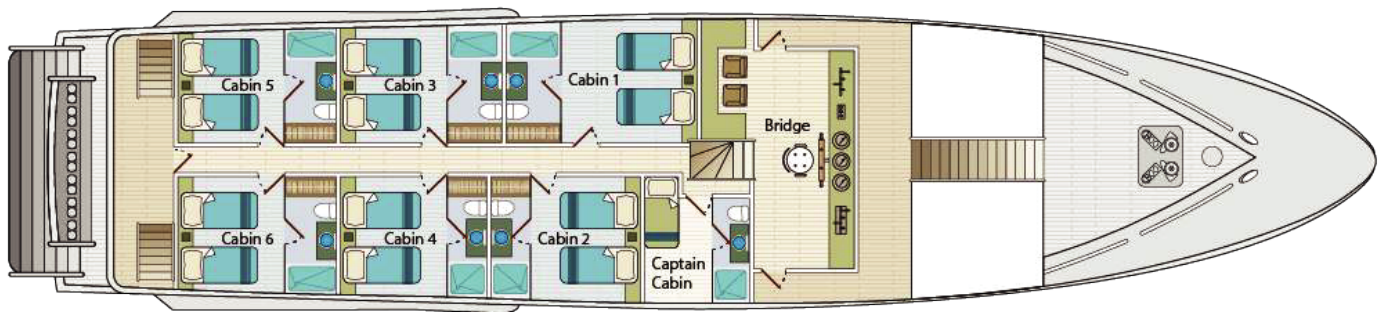

MAINDECK

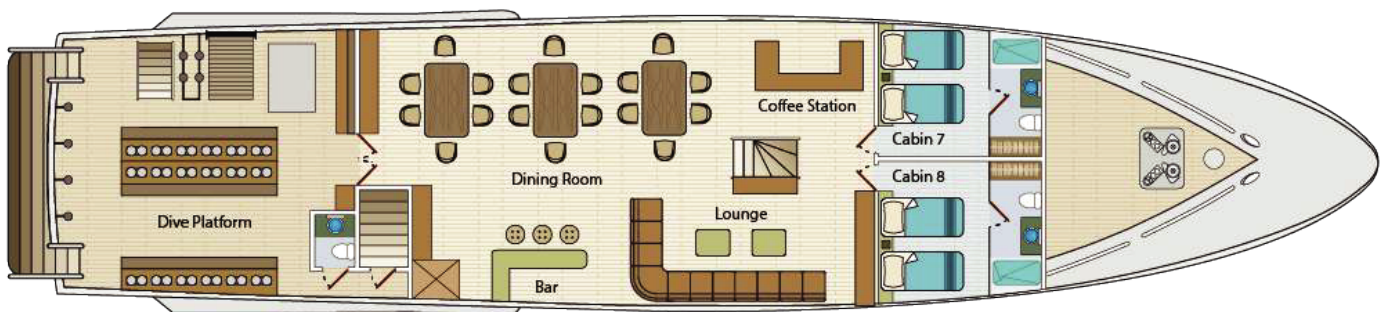

LOWERDECK

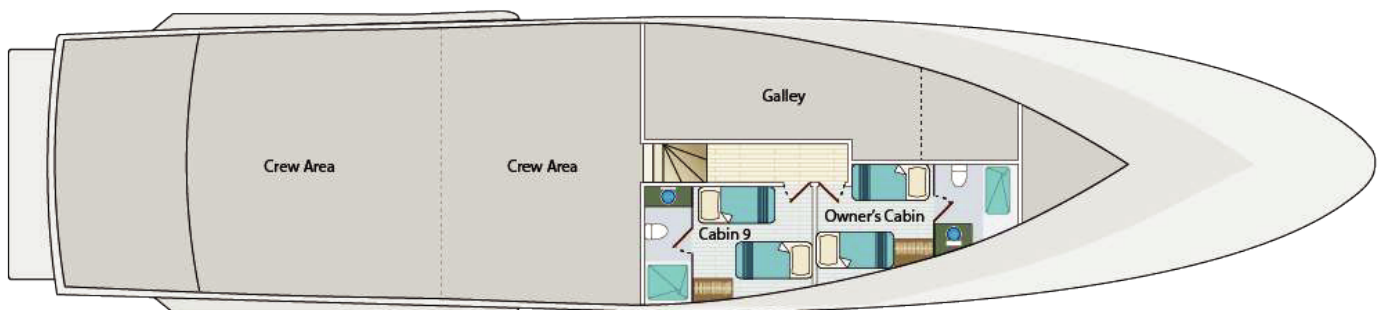

Diver Experience Needed

There is a reason the Galapagos is considered the best pelagic diving on the planet. Because it is. Darwin and Wolf are home to the world's largest shark biomass at 12.4 tons per hectare (2.47 acres or 100 m²). Those amazing photos of hundreds of Scalloped Hammerheads are common sightings at Darwin and Wolf. Diving in the Galapagos is advanced due to strong currents, varying visibility and cold water. Water temperatures can range from 56 F (13 C) to 80F (26 C) depending on the season and the dive site. Galapagos is also remote. We are often at least 16 hours away from medical facilities. Diver safety always comes first. Please read the following as you do need to acknowledge you have read it on the Diver Application Form which must be completed and returned prior to a confirmed reservation. You are the best person to assess your diving fitness.

Please use the following suggestions for self-assessment:

- ▶ All divers must be certified as open water scuba divers by an internationally recognized certification organization.
- ▶ All divers must be in good health and good fitness. We recommend a stress test for divers over 55 years old.
- ▶ Minors under the age of 18 must be accompanied by an adult.
- ▶ We recommend a minimum of 50 logged dives if you are traveling between December and May and 100 logged dives if you are traveling between June and November. You should have logged at least one dive in the 6 months prior to boarding.
- ▶ Currents can be very strong. Down currents may exist. You need to be able to remain calm and have the skills to adapt in advanced diving conditions.
- ▶ You should have good bouyancy skills. We dive in 7mm wetsuits. The water is 6% more salinic than most sea water. This adds up to more bouyancy which requires more weights. Many begin heavier and are able to shed weight once adapted.
- ▶ Dives are from Zodiac RIBs, locally called pangas. Entries are a backroll from the sides. You must remove your gear in the water prior to climbing up the ladder. It is lifted up for you.
- ▶ Dives at Darwin usually require a negative entry, no air in your BC, and straight down to the platform.
- ▶ All dives are guided by a Park certified guide with the appropriate Marine Reserve certification. Due to regulations, all divers must dive with a guide at all times. The normal ratio is 1 guide per 8 divers in 2 groups that are rarely together as 1 big group.
- ▶ We offer less experienced divers a private dive guide at a cost of \$1750 per week (\$250 per day).
- ▶ All divers must have a submersible console with an SPG & depth gauge. Dive computers are mandatory and available to rent if you don't have one.
- ▶ Decompression diving is not allowed in Galapagos. The maximum allowed depth is 130' (39.62 mts) if diving air or 110' (33.5 mts) if diving Nitrox.
- ▶ Nitrox is strongly recommended. If you are not certified, with advance notice the course is available onboard at a cost of \$250.
- ▶ Alcohol is prohibited during diving activities. We have a standing rule onboard that is strictly enforced: Once you have your first drink, you are done diving for the day.
- ▶ Touching wildlife is prohibited. If previously warned, you may lose dive privileges for duration of the departure.
- ▶ Please note you will need to acknowledge that you have read and understood this information in the Diver Application Form.

Galapagos Weather & National Park Rules

Monthly temperatures and rainfall (inches)

Jan	Feb	March	April	May	June	July	Aug	Sept	Oct	Nov	Dec
Max Air Temp											
84 F	86 F	88 F	86 F	82 F	78 F	76 F	74 F	76 F	77 F	78 F	80 F
28 C	30 C	32 C	30 C	28 C	26 C	24 C	23 C	24 C	25 C	26 C	27 C
Min Air Temp											
70 F	74 F	74 F	72 F	72 F	68 F	66 F	64 F	62 F	64 F	66 F	68 F
22 C	23 C	23 C	22 C	22 C	20 C	19 C	18 C	17 C	18 C	19 C	20 C
AVG Sea Temp (These are surface temps. Thermoclines may be as low as 54 F/13 C)											
76 F	78 F	76 F	86 F	74 F	72 F	72 F	64 F	66 F	68 F	70 F	74 F
24 C	26 C	24 C	23 C	22 C	22 C	28 C	18 C	18 C	18 C	20 C	23 C
AVG Rain Inches											
1	1	2	1.5	.75	.25	.50	.25	.50	.25	.50	.50

Galapagos National Park Rules

1. Please do not disturb or remove any native plant, rock or animal on land or in the water.
2. Be careful not to transport any live material or sand to the islands.
2. Do not take any food or drink, except water, to the uninhabited islands.
4. Please do not touch, pet or feed the animals. Approaching them too closely or taking flash photography will disturb them.
5. Please do not startle or chase any animal from its nesting place.
6. Please do not leave any trash on the islands or throw any litter overboard.
7. Please follow the marked trails at all times and do not walk out of their limits.
8. Please stay with your naturalist guide who must accompany all groups on all dives or trails.
9. Please do not buy souvenirs of objects made from native Galapagos products (except for wood) especially black coral, sea lion's teeth and Galapagos tortoise shell.
10. Do not smoke on the islands

Please note that in Galapagos, the normal protocol is that if you sight whale sharks, **NO TOUCHING** You might get away with it once, but if seen touching the whale shark, normally you are done diving for the rest of the cruise

CONTACT US TODAY !!

Sales

+593-099-050-4344
+593-099-981-5500

Reservations

sales@calipsodive.com
sales2@calipsodive.com

Address

Av. Quito y Tnte. Hugo Herrera, Puerto Baquerizo
Moreno, Galapagos, Ecuador